



SPECIFICATION FOR P STYLE ENCLOSURE

- 1) **Material** :- All lids, base and body are manufactured in Mild Steel. For thicknesses of lids base and body please refer to table below.
- 2) **Preparation** :- This enclosure is completely degreased and then has an iron phosphate treatment. Paint thickness onto of this is to a minimum of 70microns
- 3) **Type of paint** :- Epoxy polyester paint
- 4) **Colour** :-Pebble Grey RAL 7032
- 5) **Characteristics of paint material** :- Exhibits excellent mechanical strength & corrosion resistance . It is also chemically resistant to many acids , oils & solvents .
- 6) **Environmental use** :- These cases are suitable for indoor use . can obtain IP54 versions which are suitable for outdoor applications
- 7) **Mechanical** :- These cases are designed to be floor or wall mounted .These enclosure are not designed to withstand large amounts of vibration or shock loads .
- 8) **IP rating** :- All our standard range of P style cases are rated at IP 23 protection . This range of cases can be modified to increase the IP rating to the customer requirements .

TABLE GIVING DETAILS OF PANEL THICKNESS FOR P RANGE OF ENCLOSURES

P DESIGNATION	THK OF SIDE PANELS (mm)	THK OF LID (mm)	THK OF BASE CHANNEL(mm)
P1	0.9	0.9	1.5
P2	0.9	0.9	1.5
P3	0.9	0.9	1.5
P4	0.9	0.9	1.5
P5	1.2	0.9	1.5
P6	1.2	0.9	1.5
P7	1.2	0.9	1.5

Note:- Please refer to Birmingham Transformers Drawing No BTD-00083 for overall dimensions see sheet 3 for details. Refer to sheet 2 for photograph showing a P style enclosure.

Standard specification for P range of enclosures .

Birmingham Transformers
Manufacturers of Transformers, Coils, Rectifier Units



Unit 6 Weston Works, Weston Lane, Tyseley, Birmingham B11 3RP.
Tel. 0121 764 5600 Fax. 0121 764 5551 e-mail sales@birminghamtransformers.co.uk

Photograph of P style type enclosure



PROJECTION

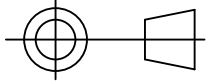

BIRMINGHAM TRANSFORMERS LTD.
COPYRIGHT

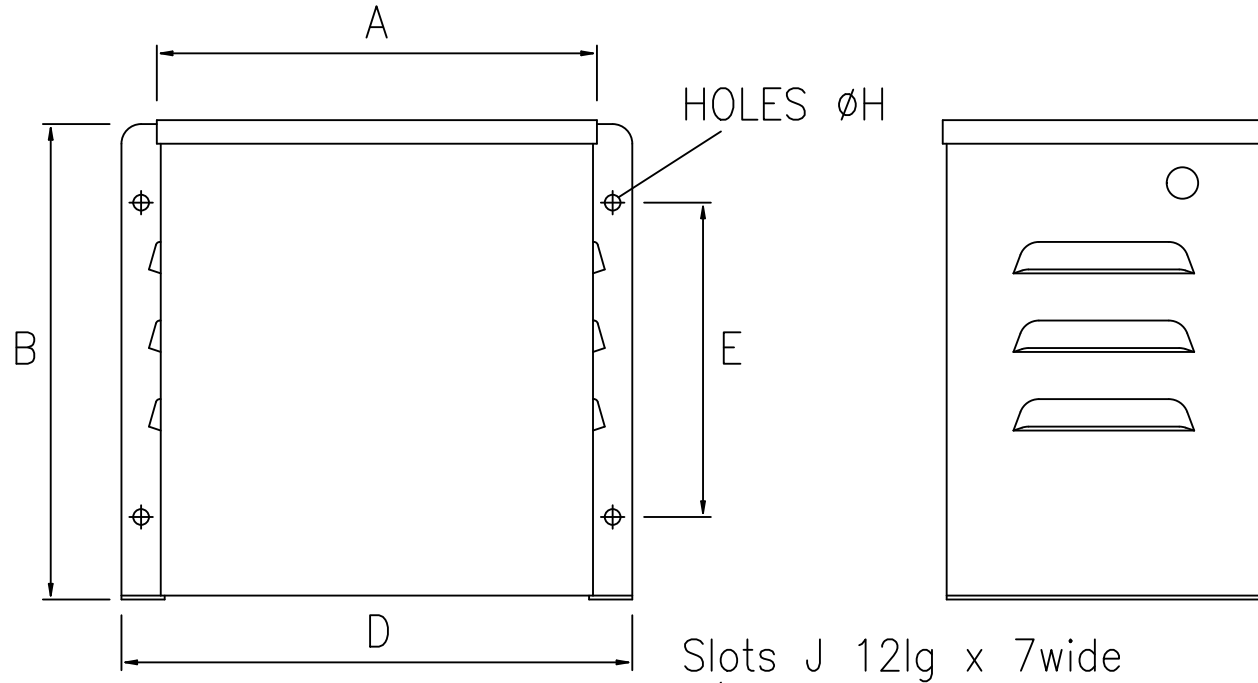

NOTE:-

- 1) Standard Paint Finish / Hammer Grey Epoxy Polyester Paint.
- 2) Available in IP23 and IP54 Versions
- 3) Suitable for Floor and Wall mounting.

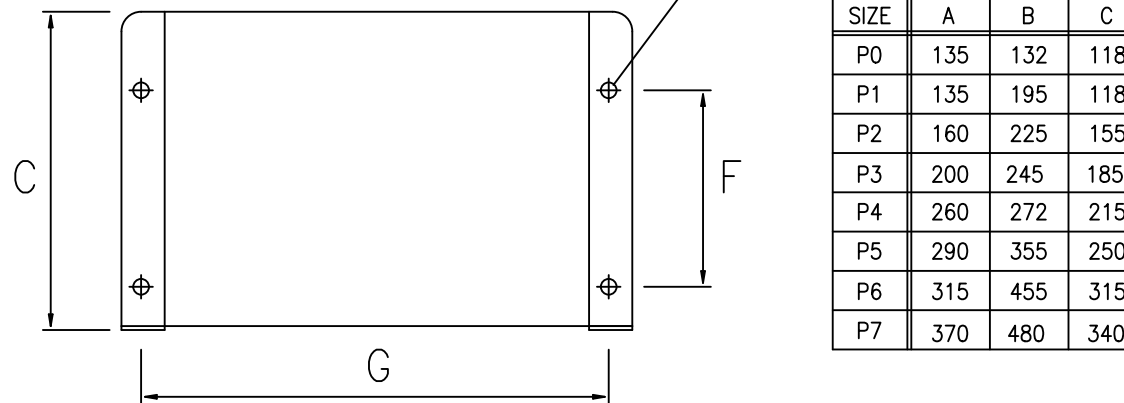

SIZE	A	B	C	D	E	F	G	H(hole)	J(slots)	wgt(kg)	Louvres
P0	135	132	118	200	74	65	160	7dia(4off)	12lgx7wd(4 off)	1	2/side
P1	135	195	118	200	126	65	160	7dia(4off)	12lgx7wd(4 off)	1.5	3/side
P2	160	225	155	220	152	103	185	7dia(4off)	12lgx7wd(4 off)	2	3/side
P3	200	245	185	270	152	114	236	7dia(4off)	12lgx7wd(4 off)	3.3	2x2/side
P4	260	272	215	340	152	114	300	7dia(4off)	12lgx7wd(4 off)	3.5	2x2/side
P5	290	355	250	350	229	159	318	7dia(4off)	12lgx7wd(4 off)	6.5	2x3/side
P6	315	455	315	385	254	161	344	7dia(4off)	12lgx7wd(4 off)	9	2x3/side
P7	370	480	340	440	254	161	399	7dia(4off)	12lgx7wd(4 off)	9.5	2x3/side

ISSUE	DESCRIPTION	APPROVED	DATE	TITLE	DRAWN	CHECKED	APPROVED	DATE	
				Outline drawing showing Range of P style enclosures	S.D.			30/06/14	
					DRAWING No. BTD-00083				
				BIRMINGHAM TRANSFORMERS LTD. Uni6 - Weston Works - Weston Lane Birmingham B11 3RP Tel no 0121-7645600 Fax No 0121-7645551 E-mail - sales@birminghamtransformers.co.uk				Birmingham Transformers Ltd.	